

• SANDER

MODEL UNI 240-KU/120

PASS HEIGHT _____

• APPROVED BY:

DATE : _____

- Even or staged parts assembly must be run through the sander as a block forming a panel that will meet the conveyor capacities in width and belts spacing. Each assembly needs a reasonable distance in order to create an opening to activate electronic eyes and to avoid assembly conflict. No gap between parts is allowed in order to complete total transfer.

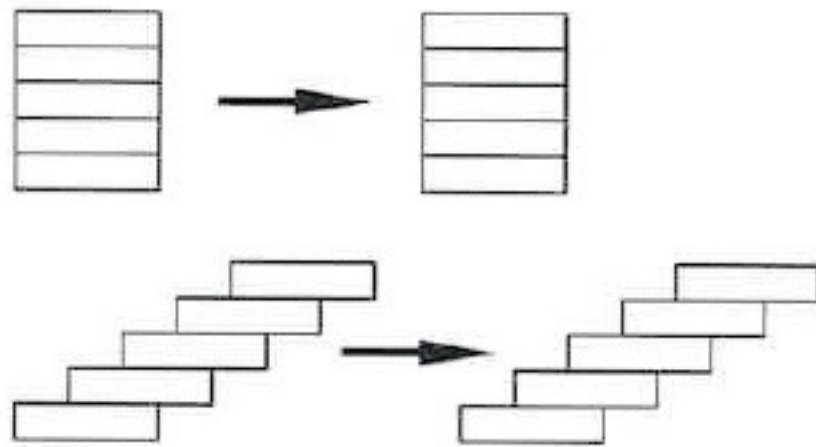

- Minimum material dimensions 4" wide by 12" long.
- Parts must be run length wise.

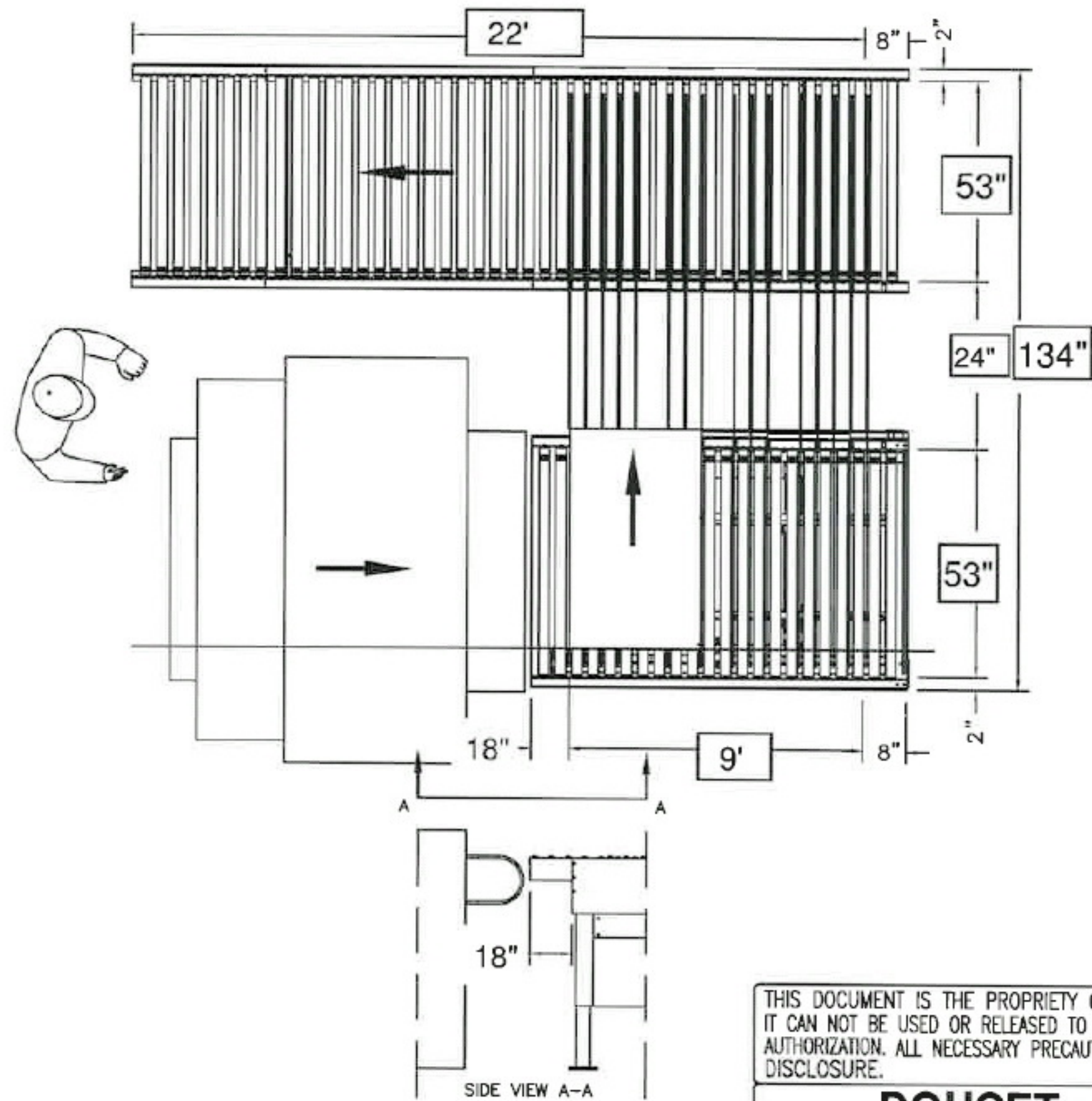

THIS DOCUMENT IS THE PROPRIETY OF DOUCET MACHINERIES INC. IT CAN NOT BE USED OR RELEASED TO THIRD PARTIES WITHOUT WRITTEN AUTHORIZATION. ALL NECESSARY PRECAUTIONS MUST BE TAKEN TO AVOID DISCLOSURE.

DOUCET MACHINERIES INC.

340, 8^e RUE, DAVELLYVILLE QUEBEC CANADA G0Z 1G0 ISO 9001
TEL (819) 367-2633 / FAX (819) 367-2100

TITLE RETURN CONVEYOR BT
FOR WIDE BELT SANDER - LH

NUMBER VLAY-027	REV. 2	REFERENCE LAYOUT	PAGE 1 DE 1
--------------------	-----------	---------------------	-------------------